









Kārearea

3 Bdrm / 169m²

Do you have an eye for sharp, modern design? Discover Kārearea. Floor to soffit windows overlook fabulous views. The generously sized kitchen has a separate pantry, there's excellent storage, and the garage has a great workshop layout.

 3 BEDROOMS	 2 LIVING ROOMS	 2 TOILETS	 1 BATHROOM
 2 CAR GARAGE	 1 WALK-IN ROBE	 1 ENSUITE	 ✓ LAUNDRY



Artists Impression Only

KEY FEATURES OF THIS HOME

- Brick veneer
- Open plan living
- Double garage

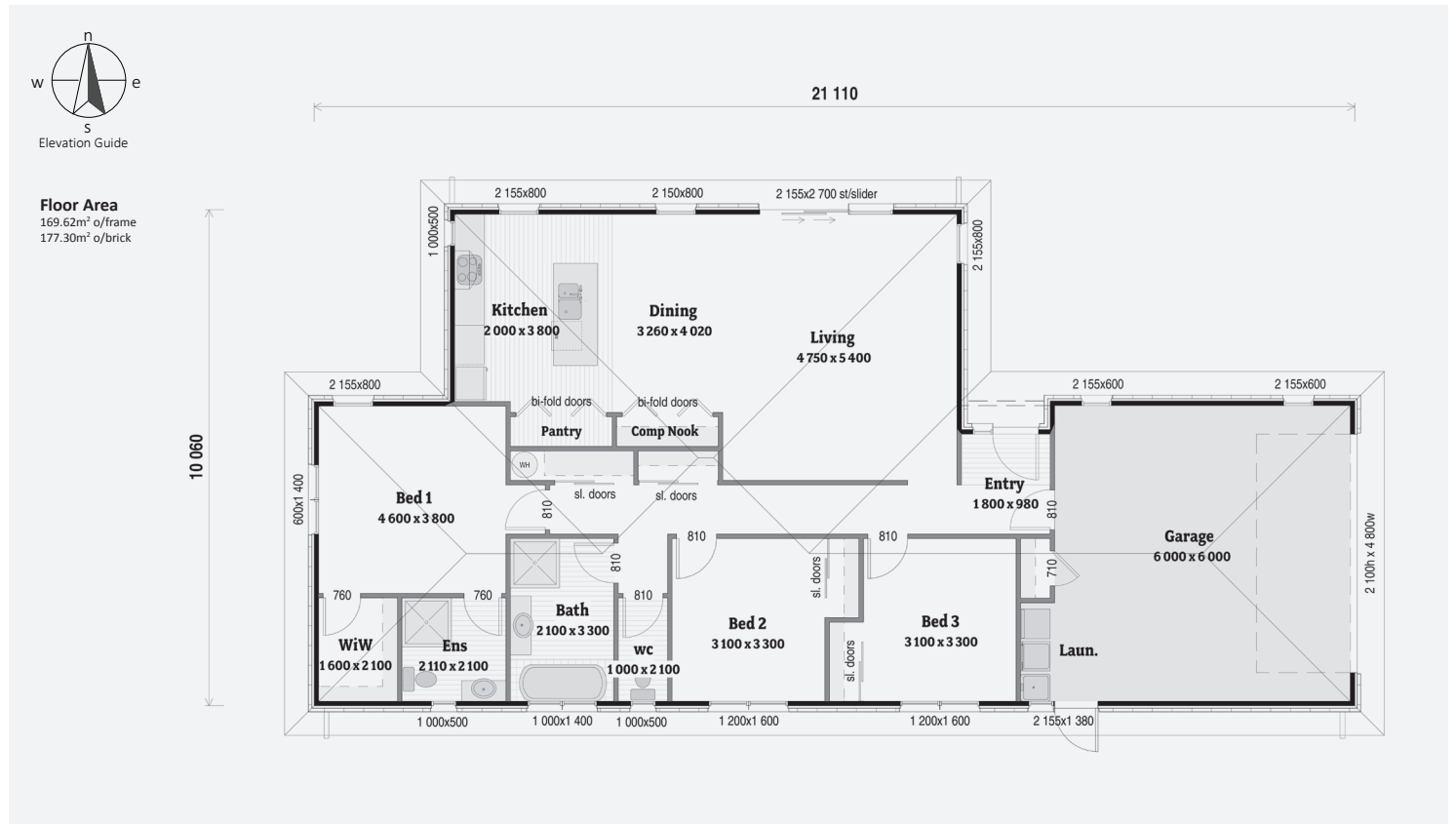

Kārearea 3 Bdrm / 169m²

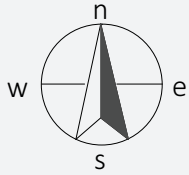

Elevation Guide

Floor Area
 169.62m² o/frame
 177.30m² o/brick

