









# Kākāpō

3 Bdrm / 159m<sup>2</sup>

Welcome home. From the front entrance, Kākāpō is all about connection and warmth. You get generous living space in a footprint that is small enough to be suitable for a standard city section.

-  3 BEDROOMS
-  2 LIVING ROOMS
-  2 TOILETS
-  1 BATHROOM
-  2 CAR GARAGE
-  1 WALK-IN ROBE
-  1 ENSUITE
-  ✓ LAUNDRY



## KEY FEATURES OF THIS HOME

- Brick veneer and weatherboard cladding
- Open plan living
- Double garage

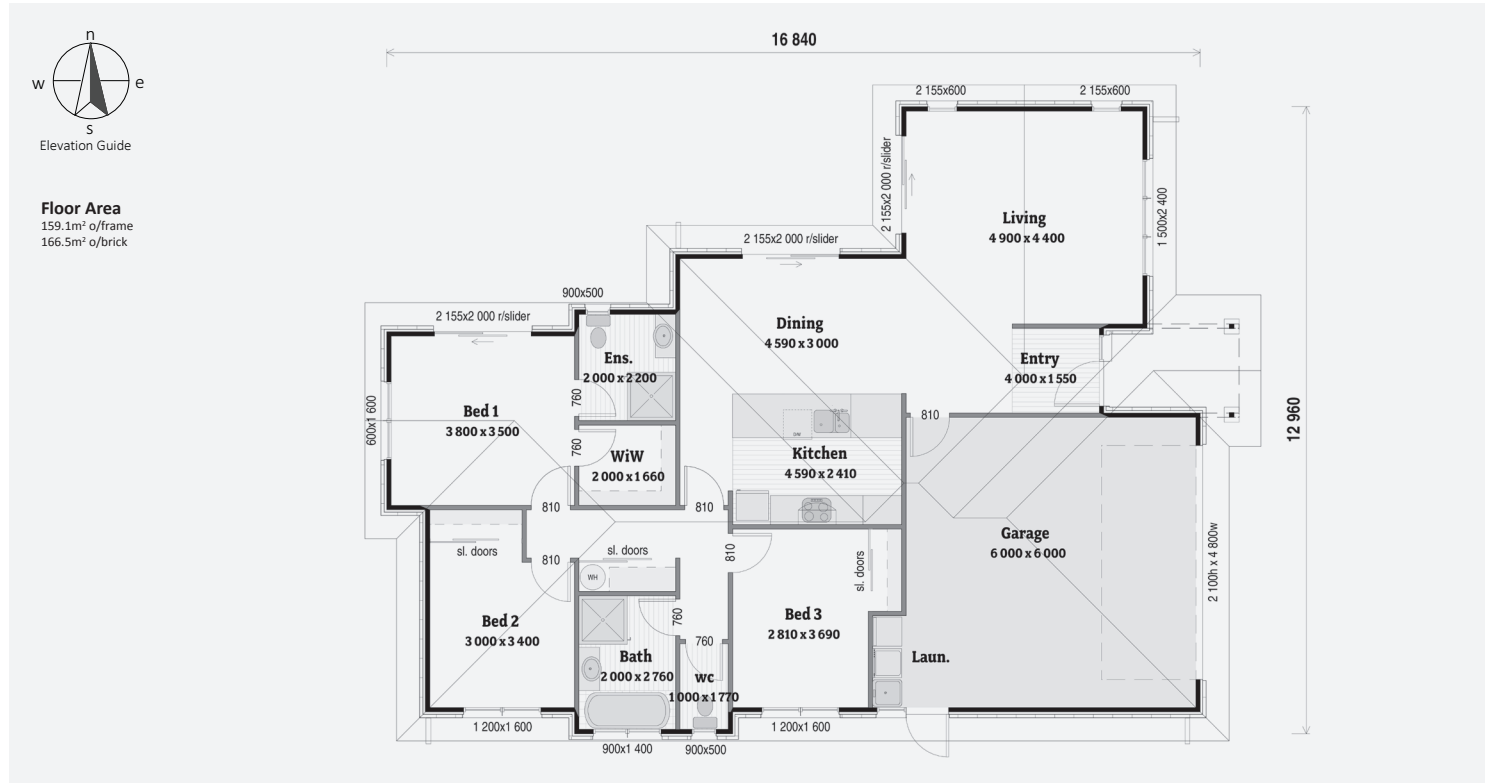

Always check the LBP Register to ensure your building practitioner is licensed.

Certified Plans are brought to you by New Zealand Certified Builders.

[www.certifiedplans.co.nz](http://www.certifiedplans.co.nz)

# Kākāpō 3 Bdrm / 159m<sup>2</sup>

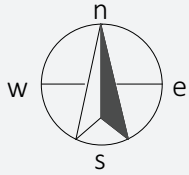

Elevation Guide

**Floor Area**  
 159.1m<sup>2</sup> o/frame  
 166.5m<sup>2</sup> o/brick

