









# Mamaku

5 Bdrm / 258m<sup>2</sup>

Feel a warm sense of welcome, right from the sheltered front entrance. Mamaku offers you four bedrooms plus private guest accommodation, all with excellent outdoor flow. The sheltered entertaining area with BBQ space links stylishly with the inside kitchen area.

 5 BEDROOMS	 3 LIVING ROOMS	 3 TOILETS	 1 BATHROOM
 3 CAR GARAGE	 1 WALK-IN ROBE	 2 ENSUITES	 <input checked="" type="checkbox"/> SEPARATE LAUNDRY



Artistic Impression Only

## KEY FEATURES OF THIS HOME

- Brick veneer and weatherboard cladding
- Designa Schist columns
- Open plan living
- Triple garage

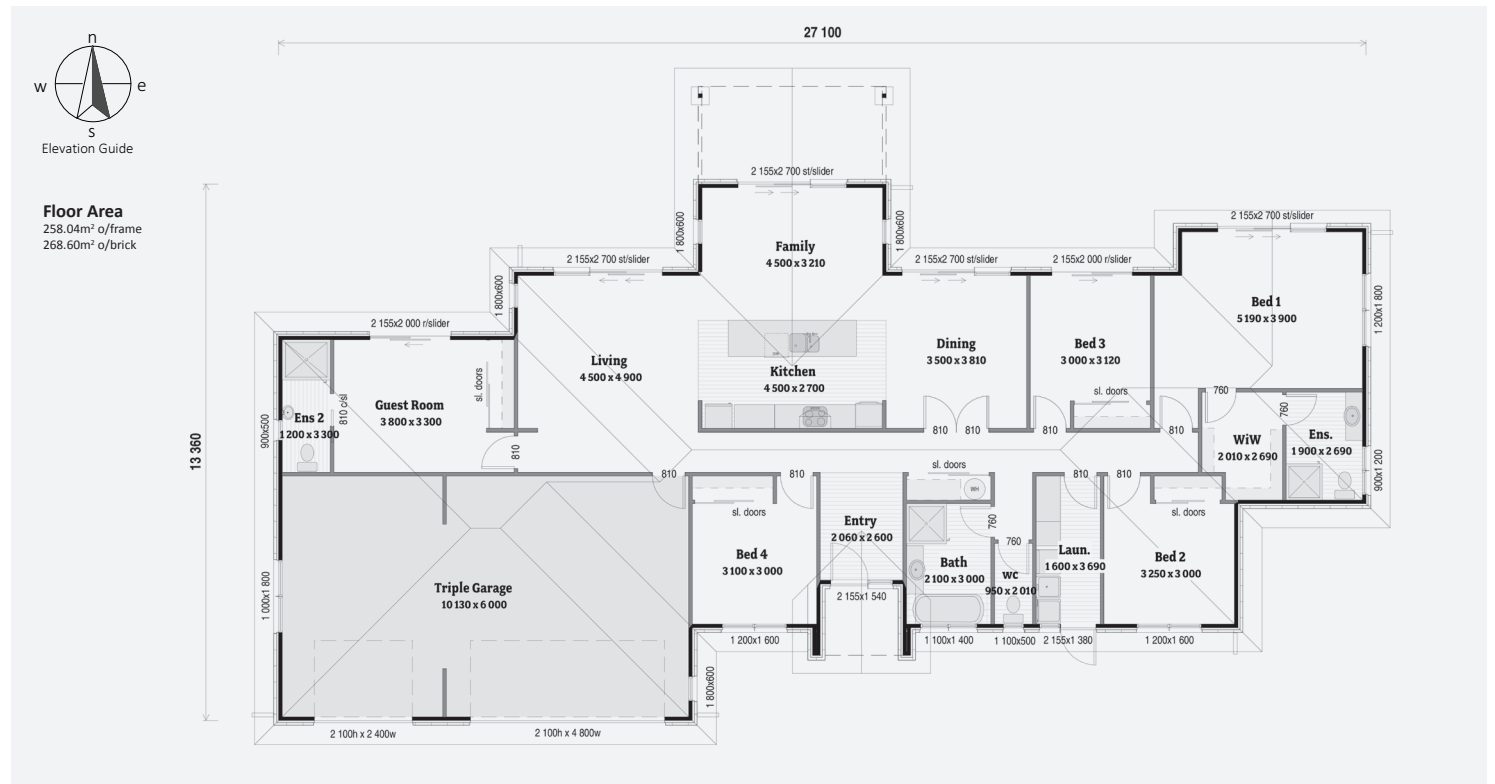



**Floor Area**  
 258.04m<sup>2</sup> o/frame  
 268.60m<sup>2</sup> o/brick

