

Pohutukawa

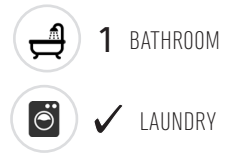

4 Bdrm / 213m²

If you have a taste for flair, Pohutukawa hits the mark. Suspended cedar shades and impressive double doors leading into a formal entry set the tone of modern, distinctive design, inside and out. Altogether a home suitable for sophisticated living.

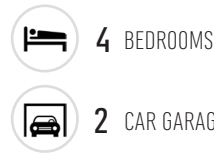

KEY FEATURES OF THIS HOME

- Axon Panel and weatherboard cladding
- Open plan living
- Ultimate outdoor living
- Double garage

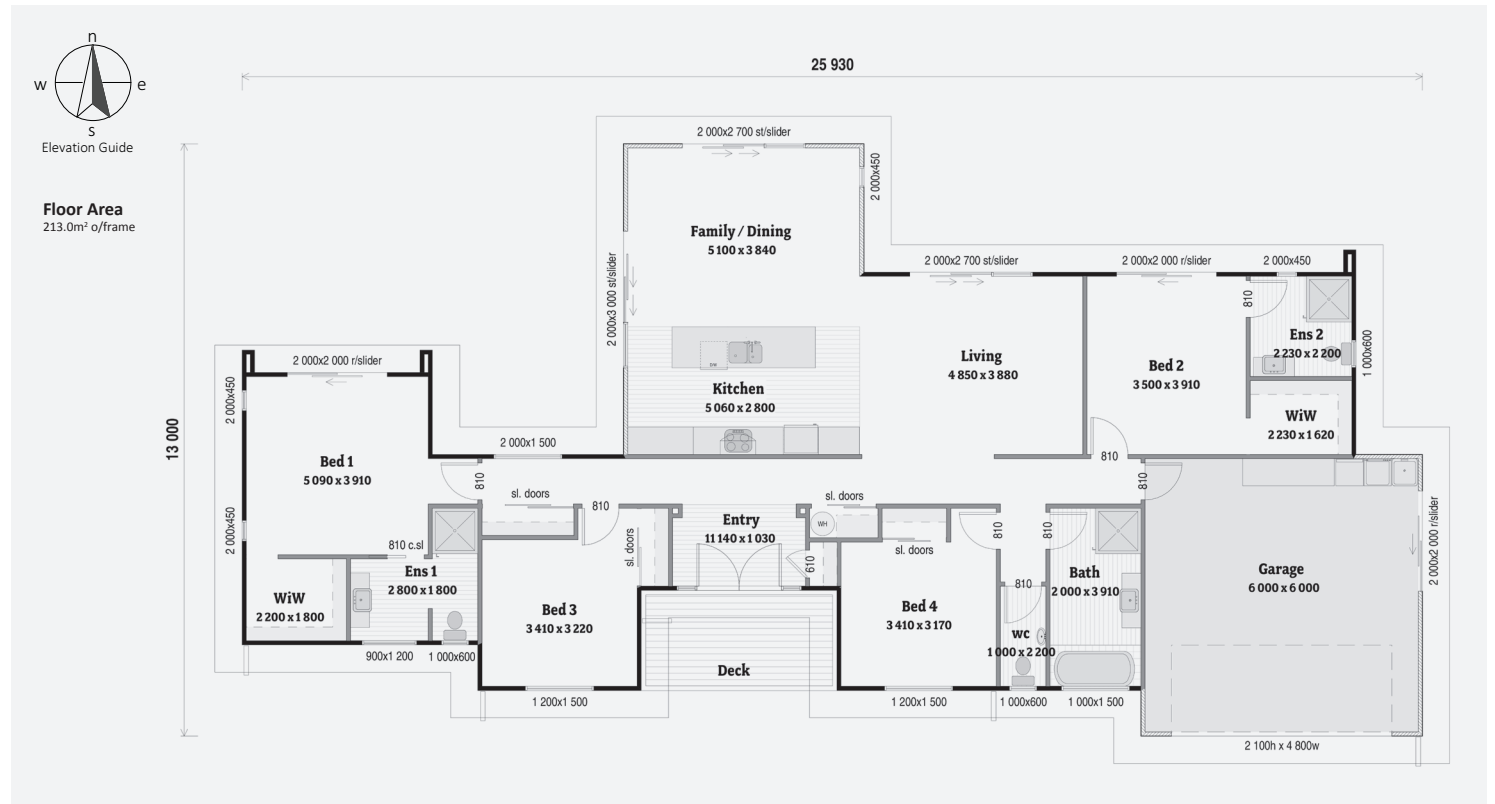



Floor Area
213.0m² o/frame

25 930

13 000

