









# Harakeke

-  3 BEDROOMS
-  2 LIVING ROOMS
-  2 TOILETS
-  1 BATHROOM
-  2 CAR GARAGE
-  1 WALK-IN ROBE
-  1 ENSUITE
-  ✓ LAUNDRY

3 Bdrm / 174m<sup>2</sup>

The commanding kitchen offers everything you could want – an entertainer’s delight. Add the sheltered and welcoming front entrance, and the pleasing exterior lines, and this is a home to really connect with.



Artists Impression Only

## KEY FEATURES OF THIS HOME

- Bevelback weatherboard and ply/batten cladding
- Open plan living
- Double garage

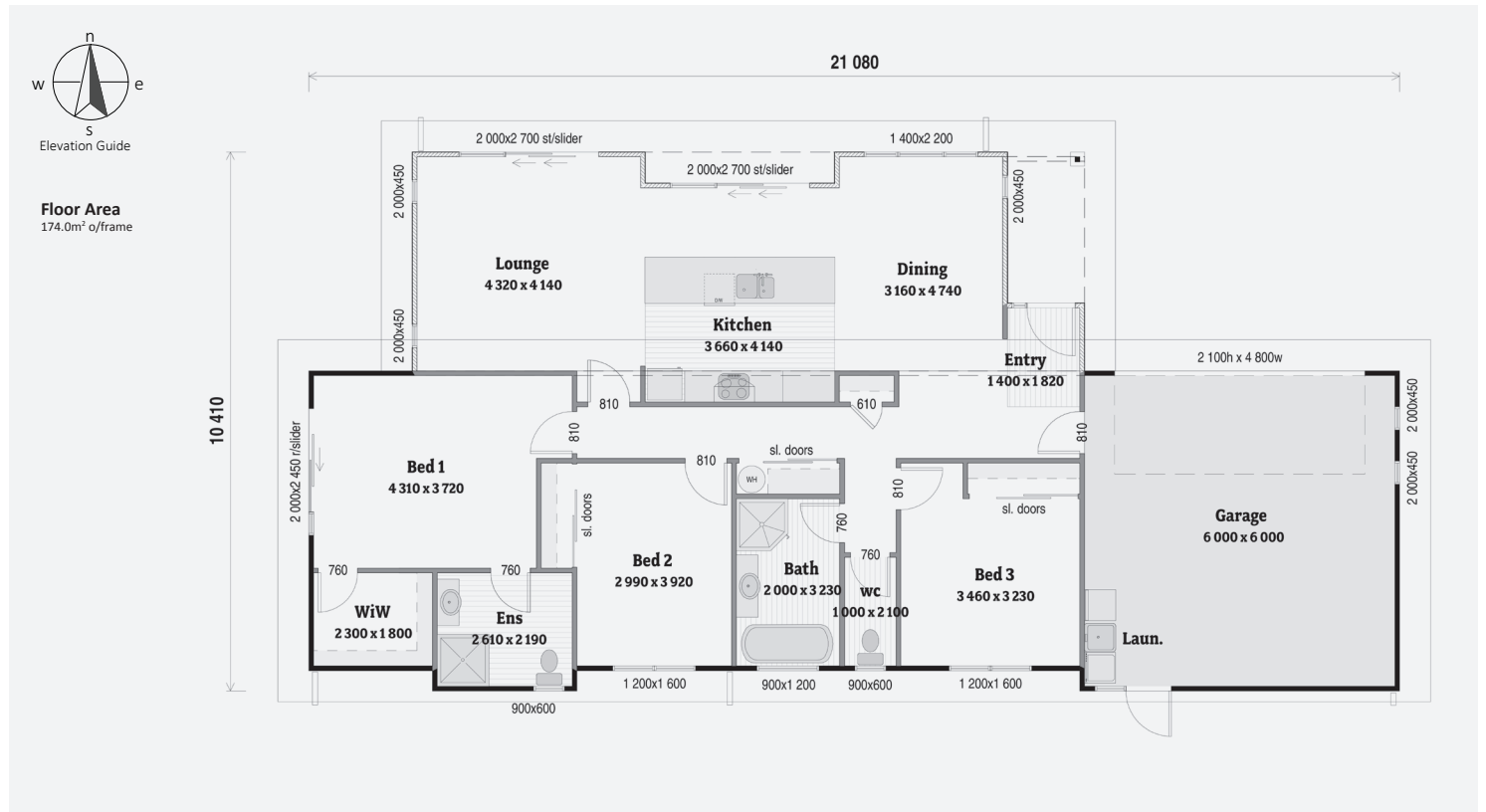



21 080

**Floor Area**  
174.0m<sup>2</sup> o/frame

